

- 1
- 2
- 3
- 4
- 5
- 6
- 7
- 8
- 9
- 10
- 11
- 12
- 13
- 14
- 15
- 16
- 17
- 18

MATERIAL

Glass-fibre reinforced polyamide based (PA) technopolymer, grey-black colour, matte finish.

BOSS CAP

- ECA.W: glass-fibre reinforced polyamide based (PA) technopolymer, in Elecolors colours, matte finish, press-fit assembly. Supplied, removable by a screwdriver.

Available also as accessory sold separately (see table).

STANDARD EXECUTIONS

Brass boss, threaded pass-through hole.

- **ESN-B**: with cap.
- **ESN-FP**: without cap.

OTHER EXECUTIONS ON REQUEST

Also available with standard metric holes.

ERGONOMY AND DESIGN

The slightly concave marks on the wing help to position the fingers in order to apply the maximum force when turning.

ACCESSORIES ON REQUEST

- ECA.W: glass-fibre reinforced polyamide based (PA) technopolymer boss cap, in Elecolors colours, matte finish, press-fit assembly (see table).



ECA.W

Code	Description	Cap for
29753-*	ECA.W3-*	ESN.55
29754-*	ECA.W4-*	ESN.70

* Complete with colour index (C1, ..., C17).

ERGOSTYLE® ELESA Original design 2003



design award
winner
2003

ESN-B

ESN-FP

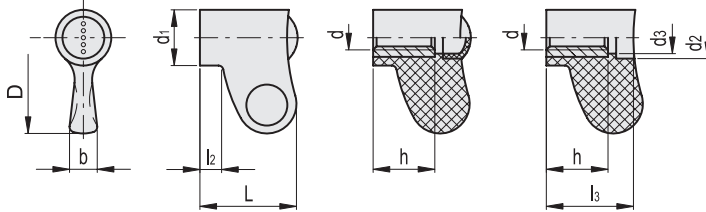

* Complete with colour index, example: 90225236-C2 ESN.55 B-1/4-20-C2



ESN.

INCH

Code	Description	D	d2B	L	d1	l2	b	h	Δ
90225236-*	ESN.55 B-1/4-20-*	1.08	1/4-20	1.1	0.63	0.26	0.31	0.71	0.04
90225241-*	ESN.55 B-5/16-18-*	1.08	5/16-18	1.1	0.63	0.26	0.31	0.71	0.04
90225406-*	ESN.70 B-5/16-18-*	1.38	5/16-18	1.42	0.79	0.31	0.39	0.79	0.07
90225411-*	ESN.70 B-3/8-16-*	1.38	3/8-16	1.42	0.79	0.31	0.39	0.79	0.07

ESN-FP

INCH

Code	Description	D	d2B	L	d1	d2	d3	l2	l3	b	h	Δ
90225132-C0	ESN.55 FP-1/4-20-C0	1.08	1/4-20	1.1	0.63	0.47	0.41	0.26	0.98	0.31	0.71	0.04
90225133-C0	ESN.55 FP-5/16-18-C0	1.08	5/16-18	1.1	0.63	0.47	0.41	0.26	0.98	0.31	0.71	0.04
90225152-C0	ESN.70 FP-5/16-18-C0	1.38	5/16-18	1.42	0.79	0.59	0.51	0.31	1.26	0.39	0.79	0.07
90225153-C0	ESN.70 FP-3/8-16-C0	1.38	3/8-16	1.42	0.79	0.59	0.51	0.31	1.26	0.39	0.79	0.07